

TECHNICAL SPECIFICATION

Connection tubes



Description:

Copper pipes with galvanic tin coating, used for joining of copper rigid or multicore conductors with different sections. The assembling is made by mechanical pressing with crimping tool.

Technical data:

- Material: copper alloy
- Coating: tin
- Application: general

Variants and dimensions:

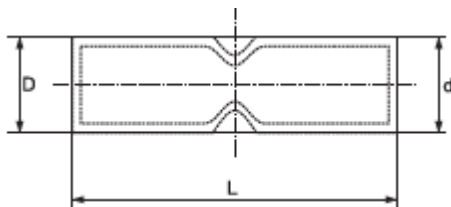

Type	Length L (mm)	Outer diameter D (mm)	Inner diameter d (mm)	Cable (mm ²)	Packing / Box (pcs)	Catalogue number
GTY-4	20	5	3	4	1000/16000	59213
GTY-6	25	5.3	3.7	6	500/1500/12000	59201
GTY-10	30	6.3	4.5	10	500/1500/12000	59202
GTY-16	35	7.5	5.7	16	100/200/4800	59203
GTY-25	40	9	7.2	25	100/500/2000	59204
GTY-35	45	10.8	8.5	35	100/200/1600	59205
GTY-50	50	12.5	9.8	50	20/200/1600	59206
GTY-70	55	14.5	11.5	70	10/100/800	59207
GTY-95	60	17	13.7	95	10/80/640	59208
GTY-120	65	19	15	120	10/60/480	59209
GTY-150	70	21	16.7	150	10/50/400	59210
GTY-185	75	23	18.5	185	10/40/320	59211
GTY-240	80	26	21	240	10/30/240	59212

Standard:

EN 61 238-1

